

Greencastle Supply Chain Hub Center Visitor Safety and Welcome Guide



1378 Armada Drive
Greencastle, PA 17225
Phone: (717) 593-2200
Fax: (717) 593-2230
www.armada.net

Welcome to Armada. We are committed to providing you with a safe and pleasant visit and encourage you to let us know if you have any special requirements.

Your Arrival and Stay

Visitors are asked to present themselves to the Main Entrance upon their arrival to and departure from the facility. A staff member will then greet and escort visitors throughout the facility. Visitors are not permitted to tour the facility or be on the facility floor without an Armada escort.



Safety Hazards

- Visitors should be sure to watch out for moving equipment.
- If you should observe an imminent danger situation (i.e., a situation in which any delay in controlling it has the potential to cause immediate and/or acute injury or death), please report it immediately to a Supervisor or Manager.
- While our normal operations do not present significant safety hazards, visitors and unauthorized individuals are expected to maintain a safe distance in areas where maintenance activities - such as battery changing and equipment movement - are being performed.
- Visitors are not permitted to operate any equipment.

Accidents and First Aid

- Please immediately report any accidents or first aid needs to a staff member.
- First aid kits can be found in the five production floor computer workstations, in the administrative area and in the Gate House.
- For an extreme emergency, dial 911.

Regulations for Our Facility

- No photography, videography or audio recording allowed on premises
- No food or drink permitted in the warehouse
- Doors must remain secured at all times
- Smoking only permitted in designated areas outside of the building

Facts and Features

- Operational since December 2013
- 34 dock doors with state of the art dock lock feature
- Projected 70 inbound and outbound truckload shipments processed daily
- Rail capability - Projected 15 inbound rail car shipments weekly

Environmental and Safety

- Mérieux NutriSciences (previously known as Silliker) audited
- LEED certified
- Key partner in Armada's Sustainability Program
- PENNSAFE Hazmat Tier II
- Ammonia refrigeration system
- Motion-controlled LED lighting
- On-site generator w/fuel containment system
- Video surveillance (interior & exterior)
- Secure driver check-in area

Storage Area	Square Footage
Total Facility	402,000
Dry Storage	254,500
Freezer Storage	83,000
Cooler Storage	12,000
Dry Dock	31,500
Cooler Dock	14,000
Rail Dock	7,000

GREENCASTLE FACILITY LAYOUT AND EVACUATION PLAN

Evacuation and Shelter-in-place

Below you will find a map of our facility layout. Please take a moment to familiarize yourself with it. In the event of an evacuation due to fire or other emergency, please quickly but calmly exit the building. We request that you report to the evacuation area next to the Gate House. Please do not stop to collect your personal belongings or attempt to re-enter the building. In the event of severe weather, please proceed to the Conference Room.

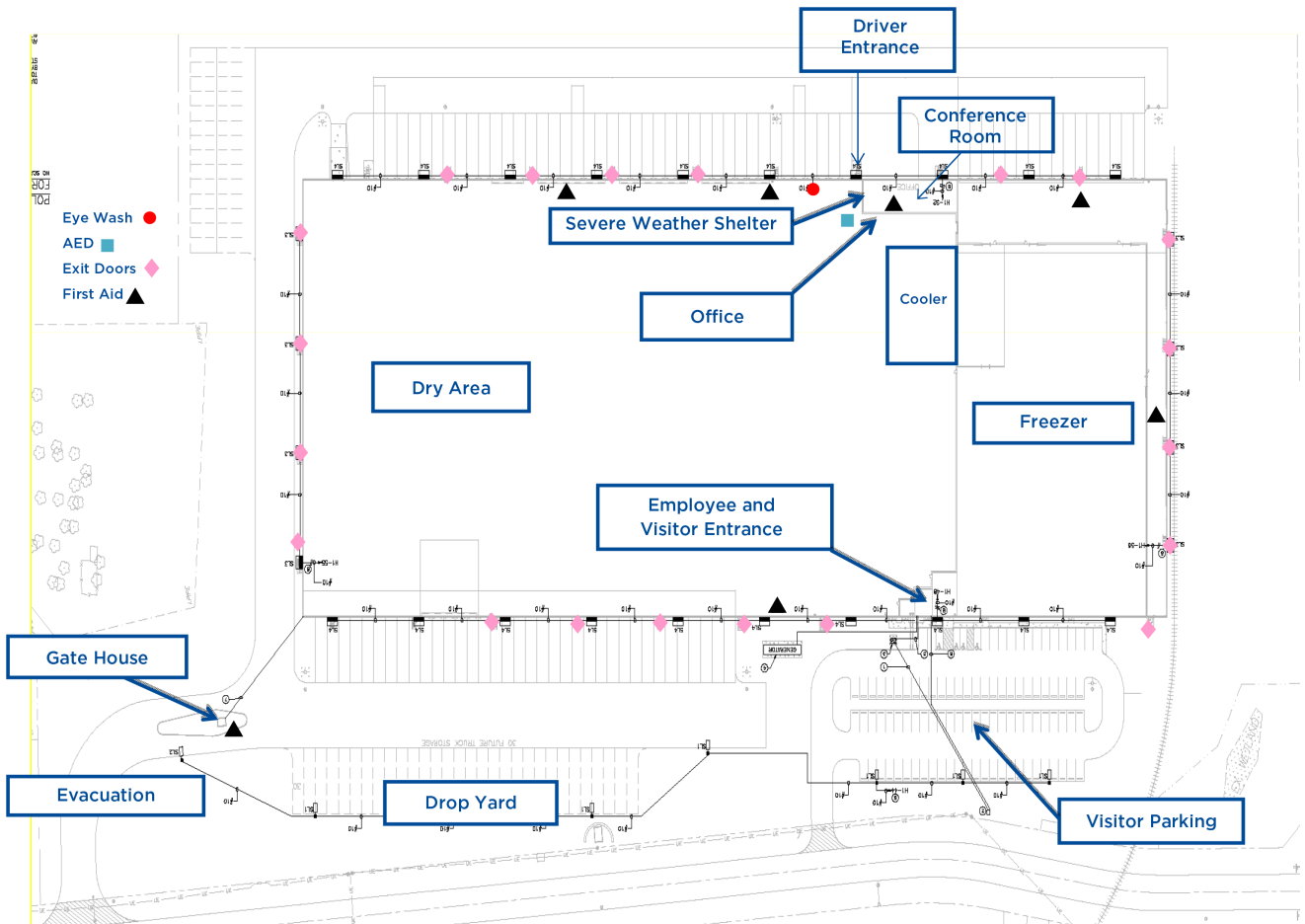

“Welcome to Armada’s Supply Chain Hub Center. This facility is an integral part of our commitment to servicing our clients. We hope that you enjoy your time with us.”

*John Burke
CEO*