

Romeoville Supply Chain Hub Center Visitor Safety and Welcome Guide



1257 N. Schmidt Road
Romeoville, IL 60446
Phone: (815) 886-7400
Fax: (815) 407-0438
www.armada.net

Welcome to Armada. We are committed to providing you with a safe and pleasant visit and encourage you to let us know if you have any special requirements.

Your Arrival and Stay

Visitors are asked to present themselves to the Shipping/Receiving Office upon their arrival to and departure from the facility. A staff member will then greet and escort visitors throughout the facility. Visitors are not permitted to tour the facility or be on the facility floor without an Armada escort.



Safety Hazards

- Visitors should be sure to watch out for moving equipment.
- If you should observe an imminent danger situation (i.e., a situation in which any delay in controlling it has the potential to cause immediate and/or acute injury or death), please report it immediately to a Supervisor or Manager.
- While our normal operations do not present significant safety hazards, visitors and unauthorized individuals are expected to maintain a safe distance in areas where maintenance activities - such as battery changing and equipment movement - are being performed.
- Visitors are not permitted to operate any equipment.

Accidents and First Aid

- Please immediately report any accidents or first aid needs to a staff member.
- First aid kits can be found near the Inventory Office, Warehouse Manager's office, Shipping/Receiving Office and the PM Manager's office.
- For an extreme emergency, dial 911.

Regulations for Our Facility

- No photography, videography or audio recording allowed on premises
- No food or drink permitted in the warehouse.
- Doors must remain secured at all times.
- Smoking only permitted in designated areas outside of the building

Facts and Features

- Operational since 2000
- 69 dock doors with safety dock lock feature
- Services include ReDistribution, storage and promotions management

Environmental and Safety

- Mérieux NutriSciences (previously known as Silliker) audited
- ISO 14001-2004 Certified
- CEPP Hazmat Tier II
- Ammonia refrigeration system
- On-site generator w/fuel containment system
- Complete video surveillance
- Secure driver check-in
- Motion-controlled lighting system
- Secure card access entry system
- SQF (Safe Quality Food) Food Safety Code for Storage and Distribution

Storage Area	Square Footage
Total Facility	460,800
Dry Storage	266,000
Freezer Storage	64,200
Cooler Storage	14,000
Dry Dock	55,200
Cooler Dock	16,600
Office Area	12,800
Innovation Center	32,000

ROMEOVILLE FACILITY LAYOUT AND EVACUATION PLAN

Evacuation and Shelter-in-place

Below you will find a map of our facility layout. Please take a moment to familiarize yourself with it. In the event of an evacuation due to fire or other emergency, please quickly but calmly exit the building. We request that you report to the evacuation area on the north side of the building. Please do not stop to collect your personal belongings or attempt to re-enter the building. In the event of severe weather, please proceed to the Shipping/Receiving Office.

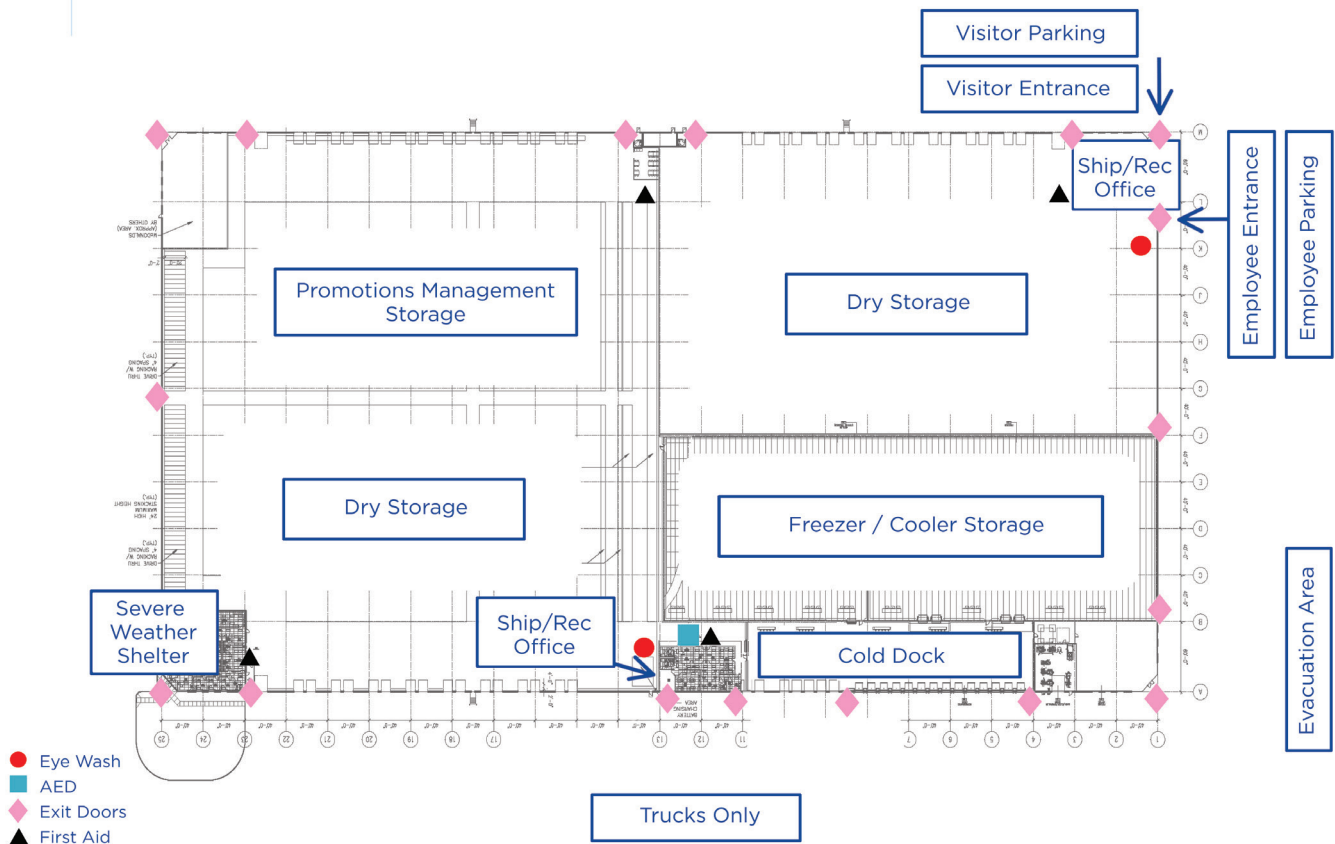

“Welcome to Armada’s Supply Chain Hub Center. This facility is an integral part of our commitment to servicing our clients. We hope that you enjoy your time with us.”

*John Burke
CEO*